



BALCONY

Balcony Systems' Juliette Balcony Installation Instructions

Using the Balcony 2 handrail

© Balcony Systems 2013

www.balconette.co.uk

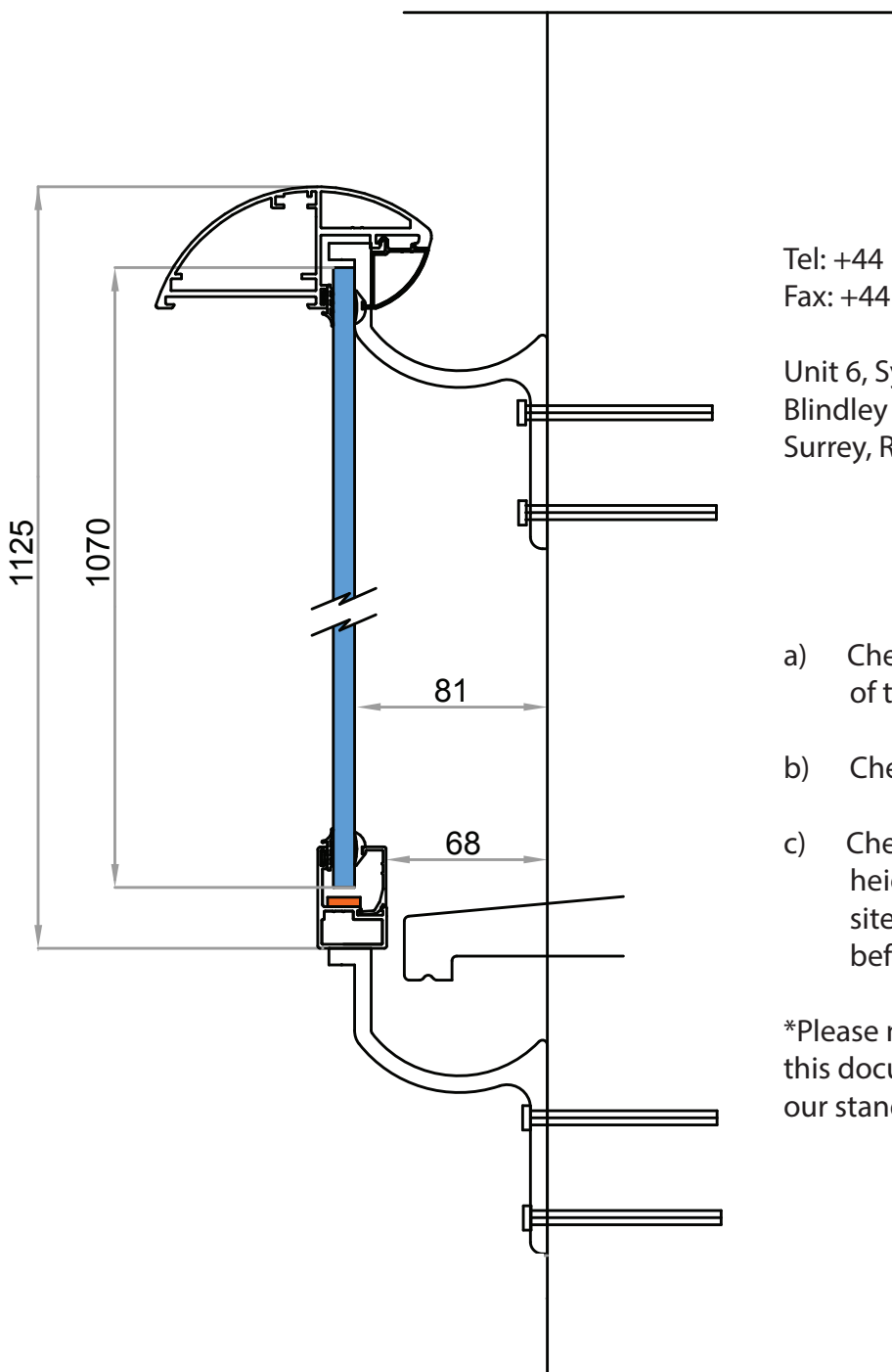

Tel: +44 1342 410411
Fax: +44 1342 410412

Unit 6, Systems House, Eastbourne Road,
Blindley Heath, Lingfield,
Surrey, RH7 6JP, United Kingdom

- Check you have all the parts of the order.
- Check the height of the glass
- Check the sizes and height against the required height on site making sure they are correct before assembling*

*Please note the indicated sizes in this document refer to our standard height.

* do not scale from this drawing

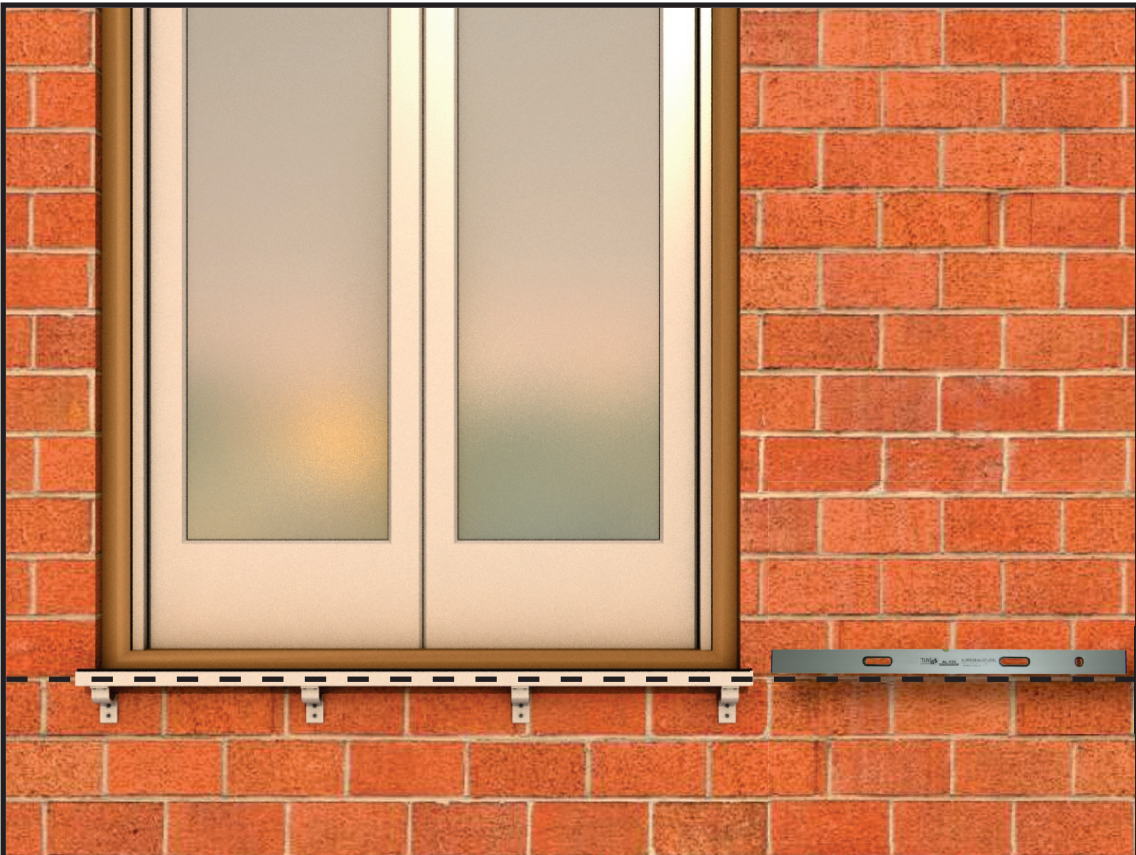

1. Line up bottom track to be centre with the window opening.

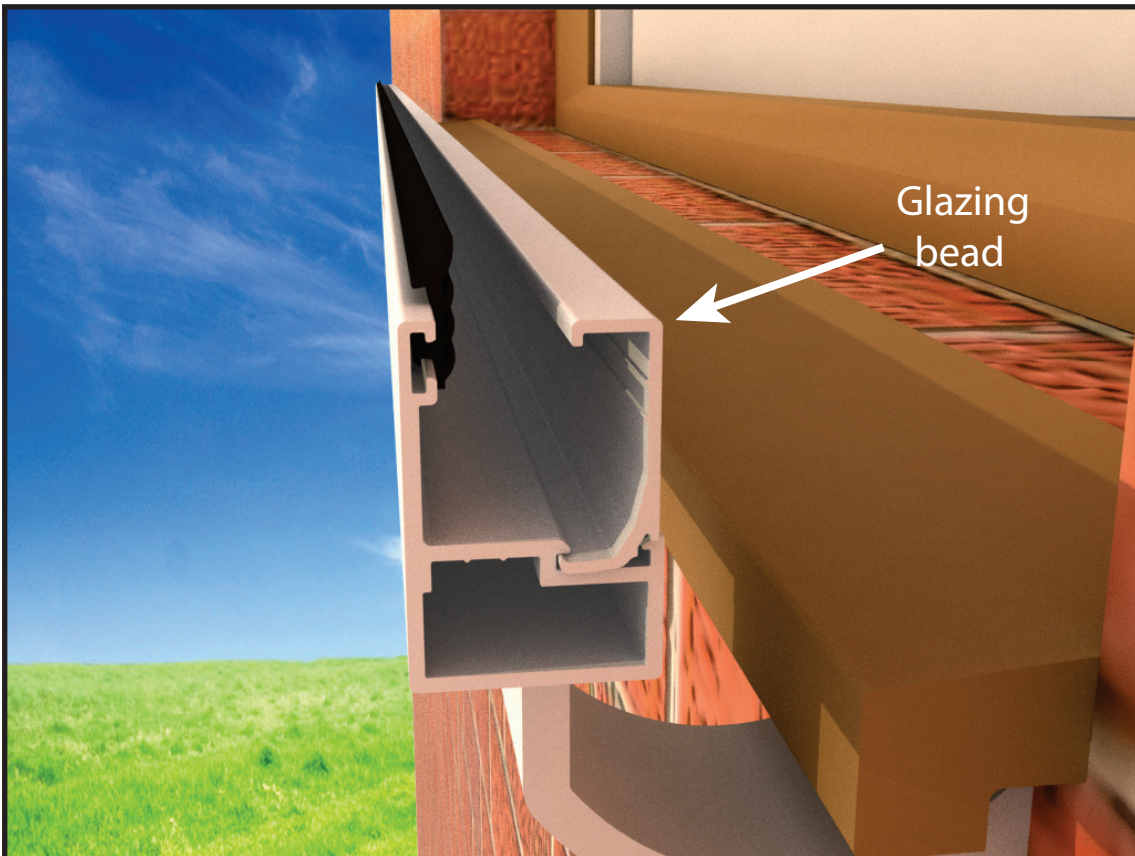

2 . Line up bottom track vertically to allow the access to the glazing bead from the inside.



3. When properly lined up fix the bottom track brackets firmly to the wall.
(use a level to make sure you are horizontally level)

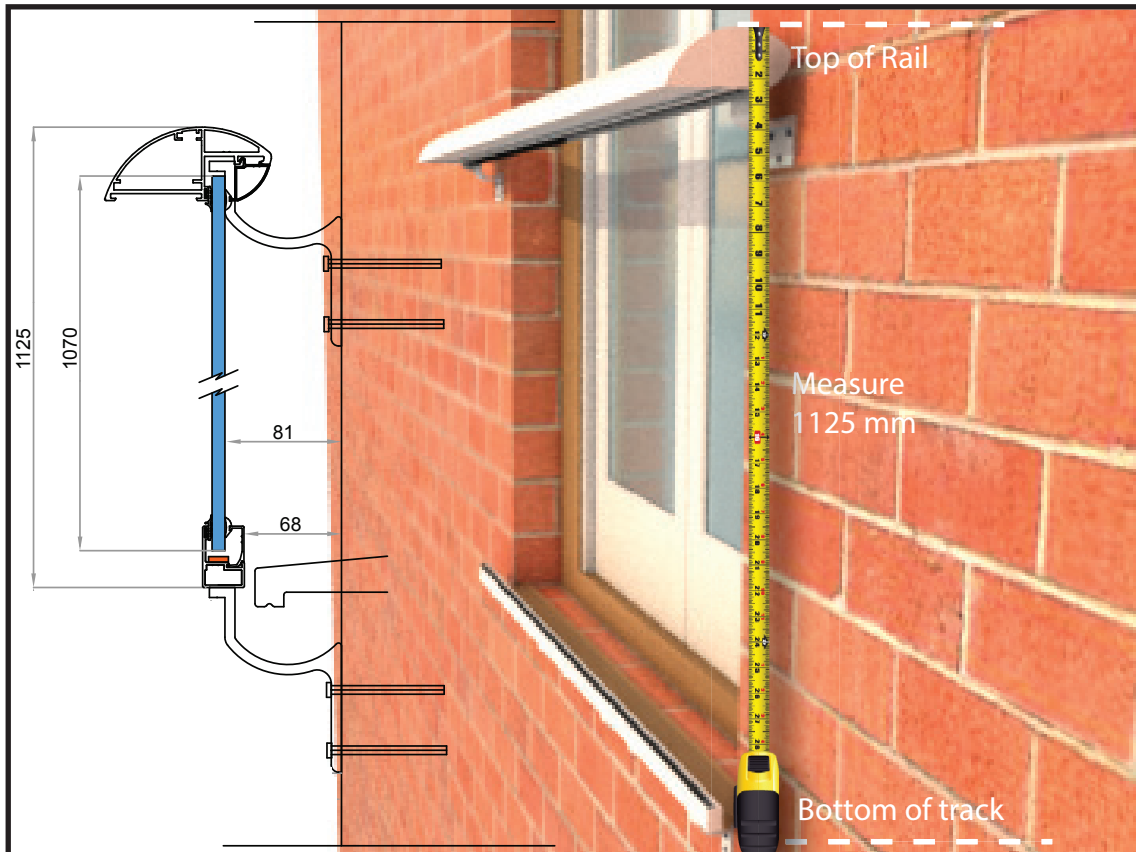

4. Measure the correct height of the handrail position (use attached drawing)
* do not scale from this drawing

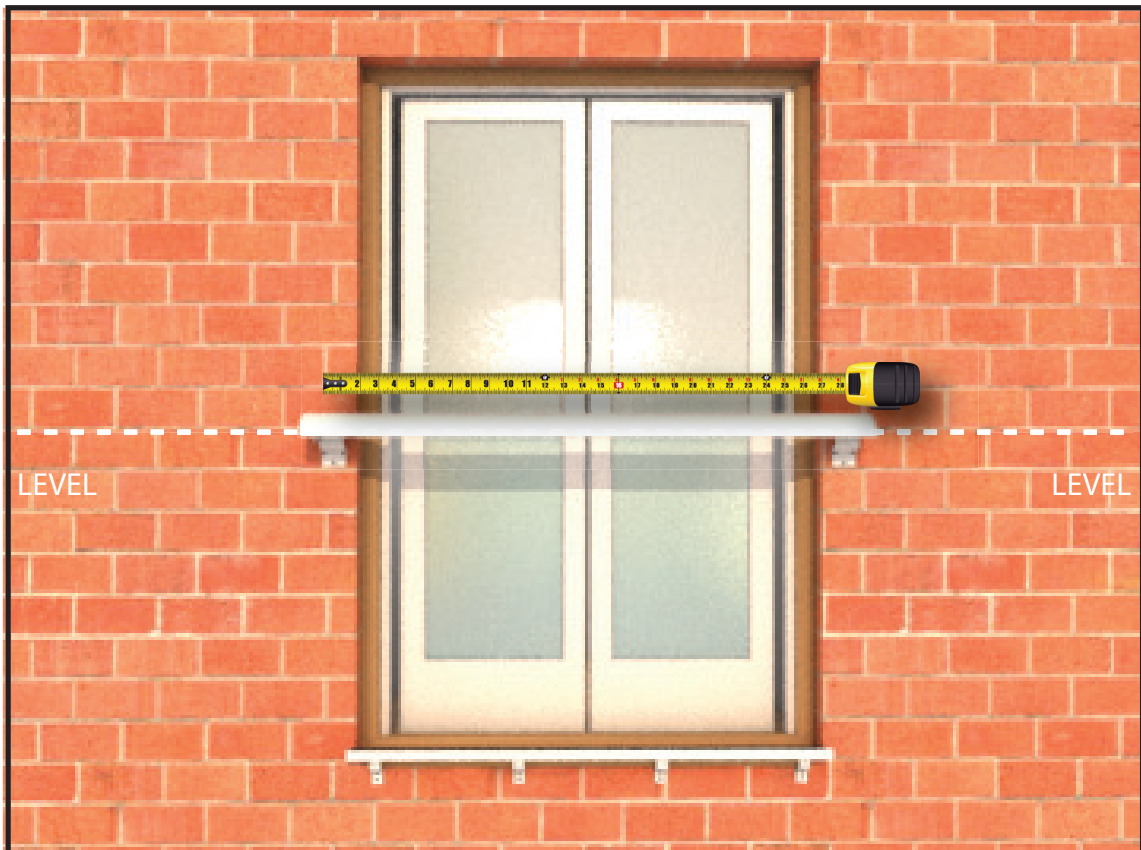

5. Center the handrail to be centre with window or equal overlap on the two sides.



6. When properly lined up fix the handrail firmly to the wall through the brackets



Glazing bead

Glazing bead

7. Remove glazing beads if in place.

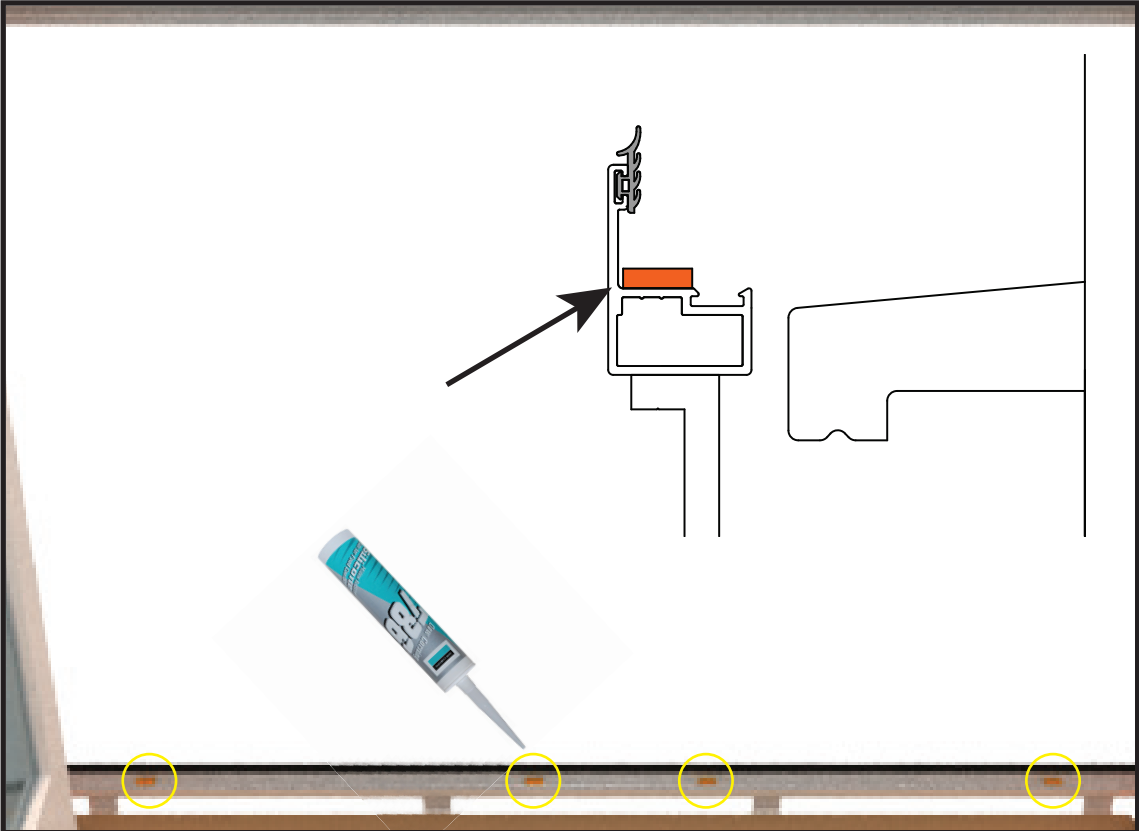

8. Place two spacers on the bottom track for each glass and use a dab of silicone to let them stay in place.



9. Remove any stickers/writing/spacers that are stuck on the glass.

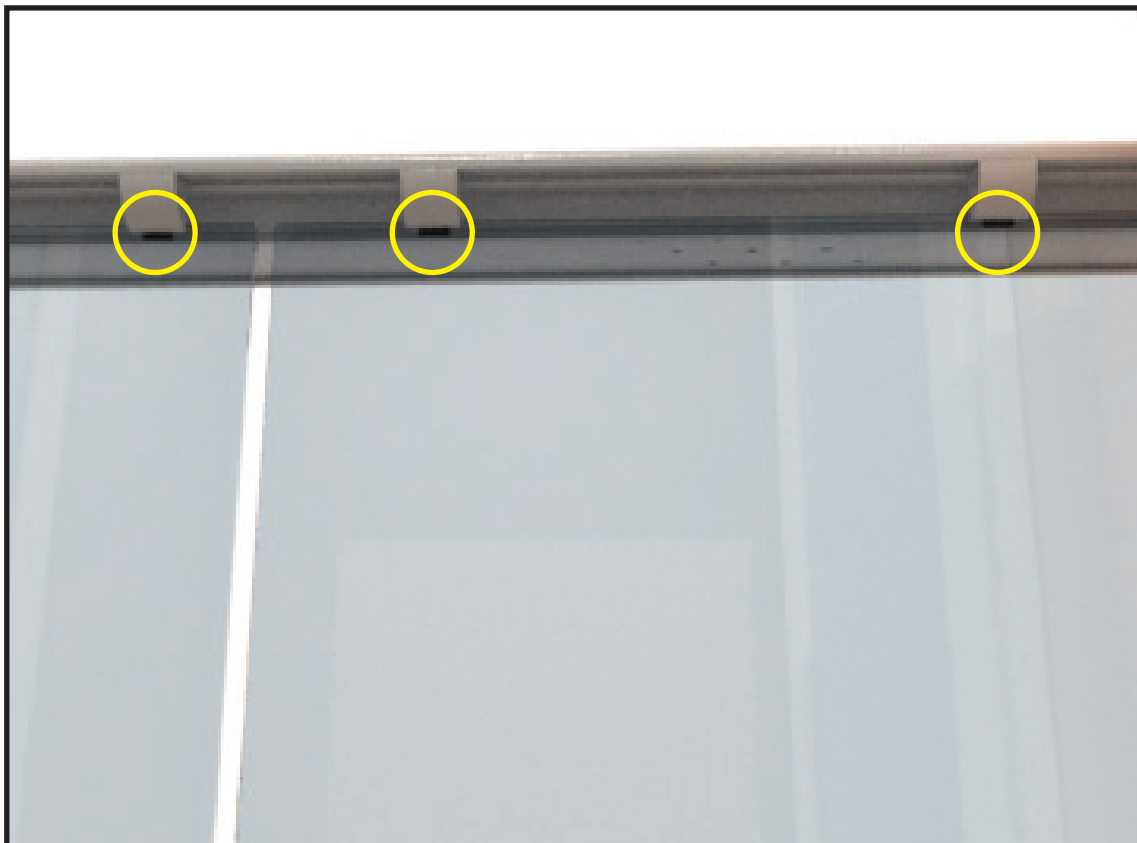

10. Place the glasses one at a time in their positions. To hold them temporarily in position use the small glazing bead pieces provided and small 3mm rubber.

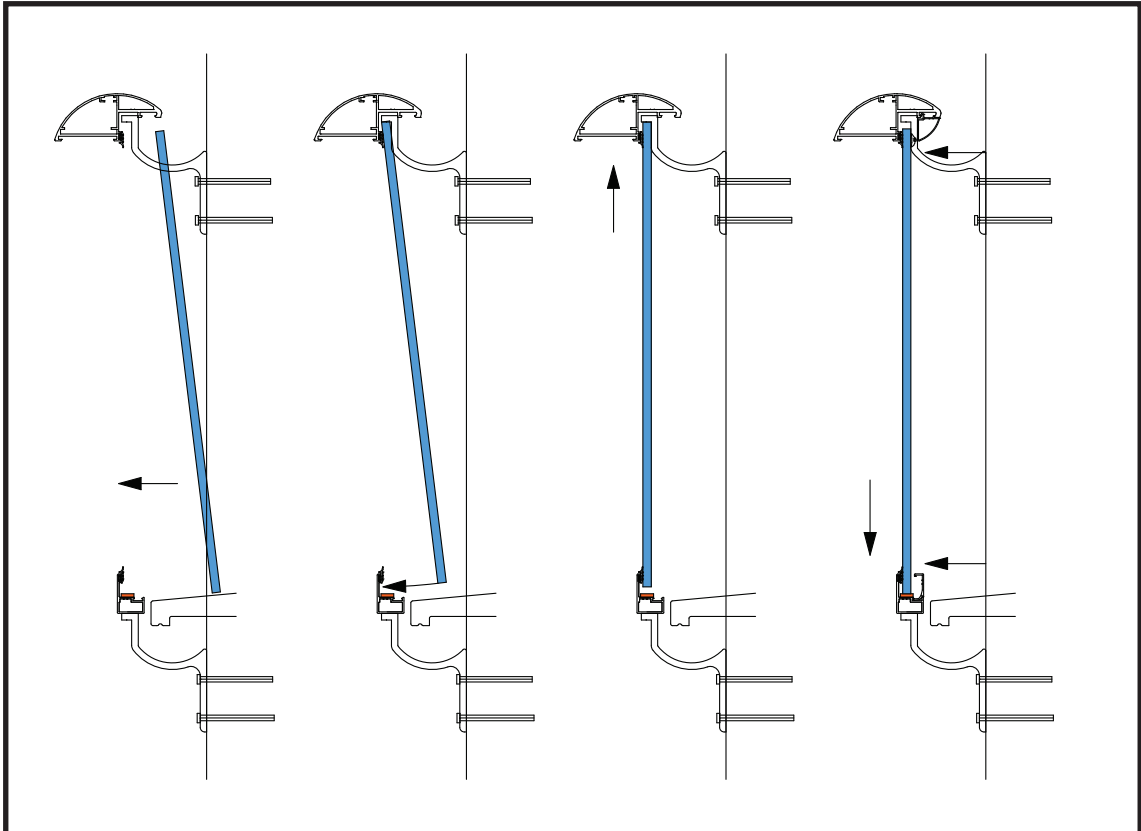

10a. Follow these instructions to insert the glass panels in place and place the temporary glazing beads and rubber gaskets into place.



11. Align all the glass heights and spaces to your satisfaction.

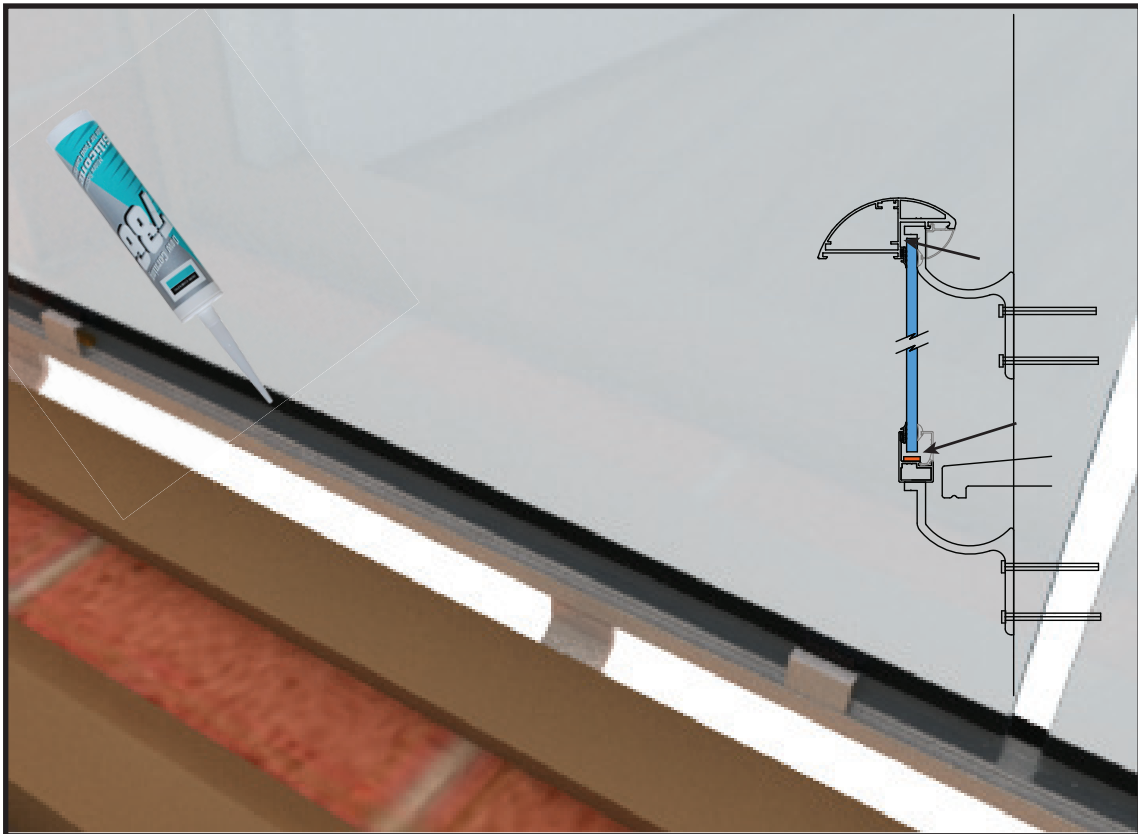

12. Using silicone fill the space between the bottom of the glass and the bottom rail, and the space between the top of the glass to the underside of the handrail.

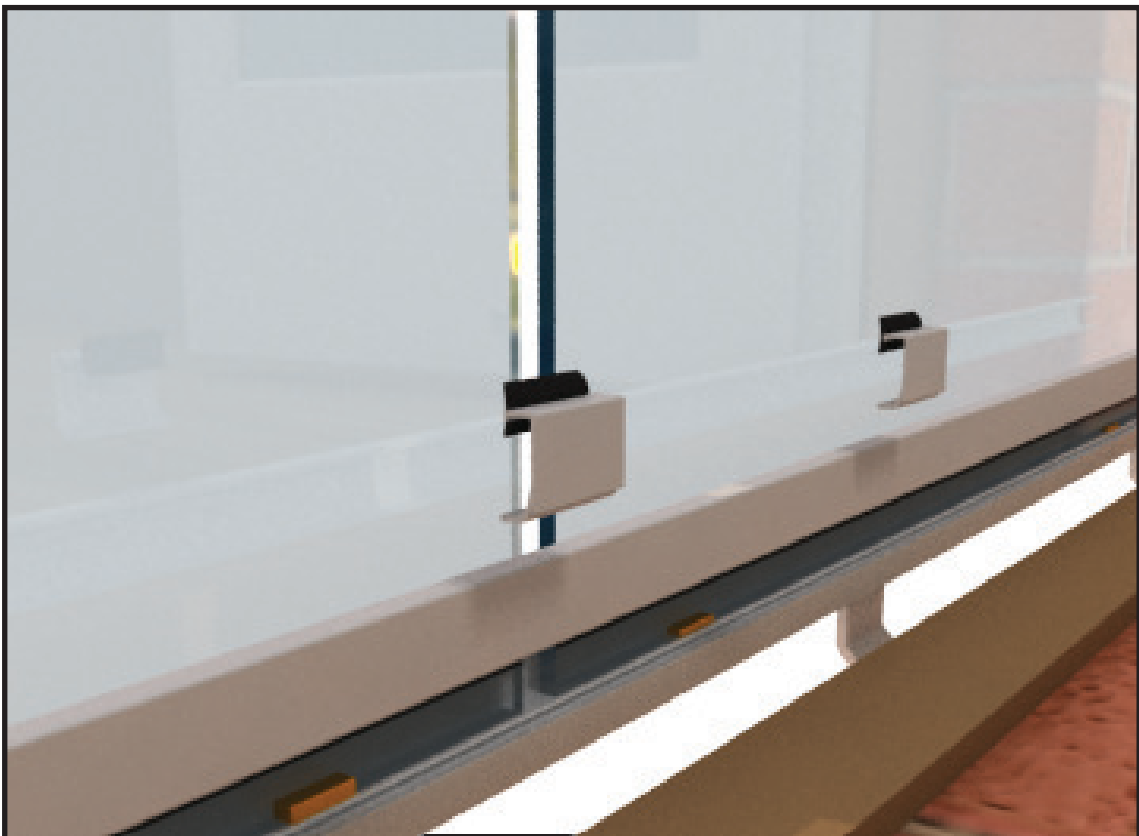

13. When the silicone is dry, replace the small glazing beads with the full length glazing beads.

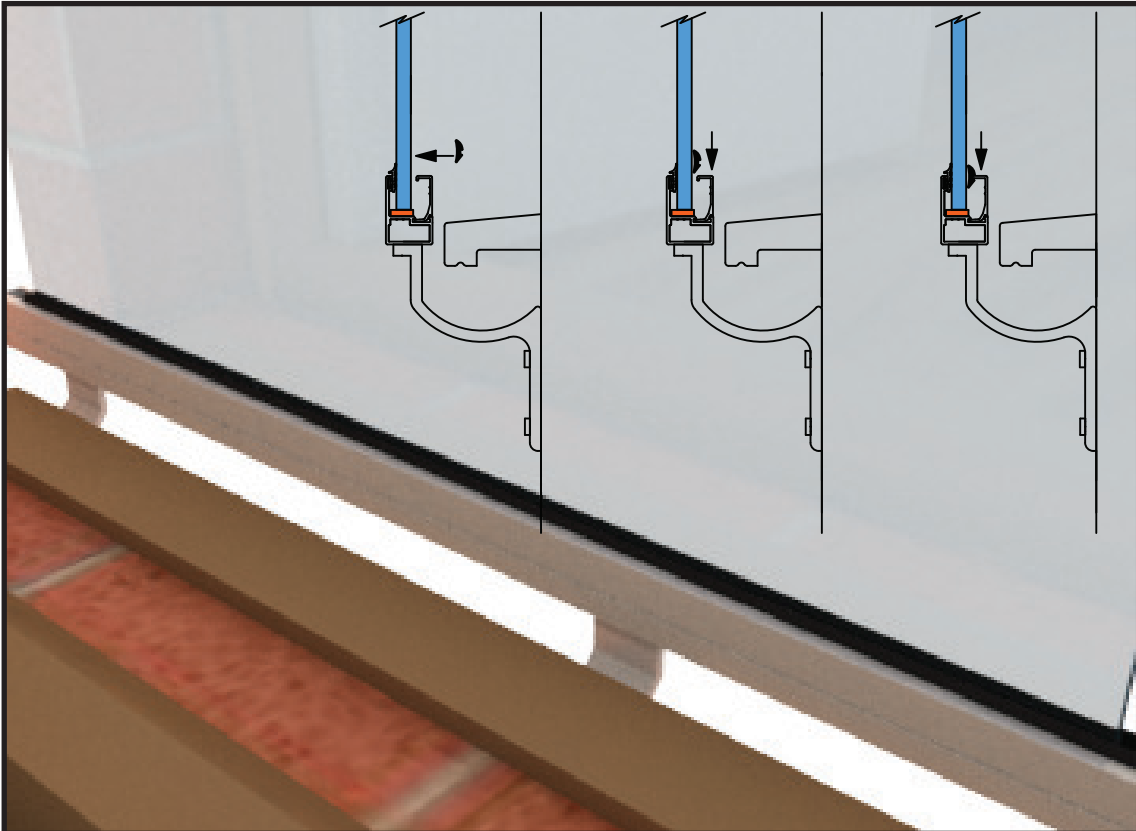

13 a. After the temporary glazing beads have been replaced with the glazing bead, fit the rubber gasket between the glazing bead and the glass. (using soap water can ease the process)

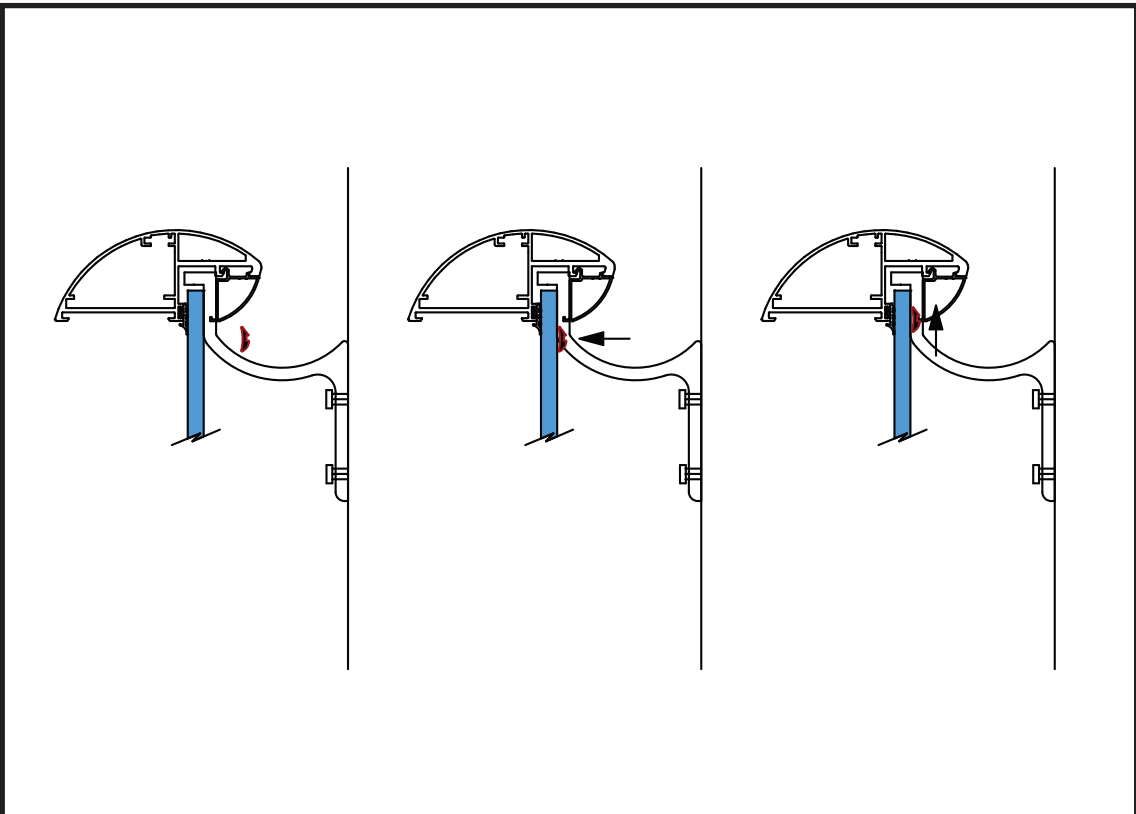

13b. Follow the same procedure for the top rail; replace the top temporary small glazing beads with the full length one and push the rubber gaskets in (using soap water can ease the process).

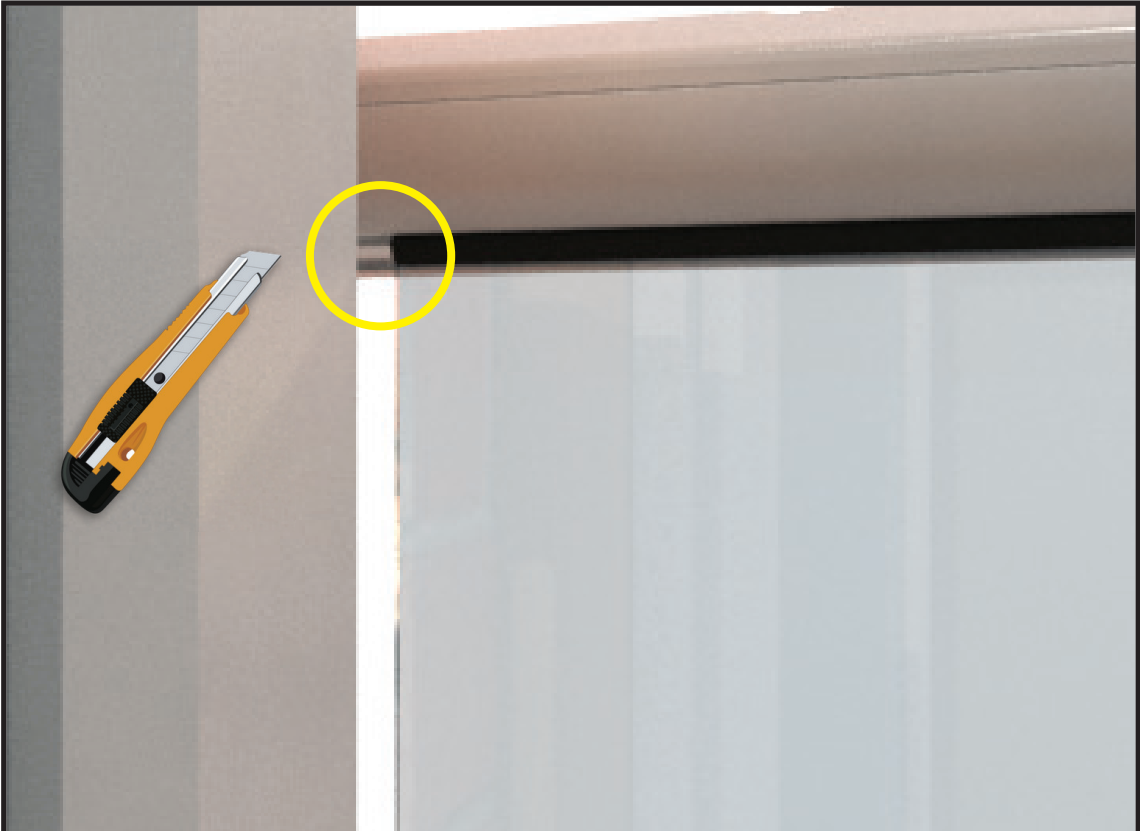

14. Trim off excess rubber.





BALCONY

© Balcony Systems 2013

www.balconette.co.uk

Tel: +44 1342 410411

Fax: +44 1342 410412

Unit 6, Systems House, Eastbourne Road,
Blindley Heath, Lingfield,
Surrey, RH7 6JP, United Kingdom